



FEATURES:

- Fault monitoring, heatsink temperatures and speaker loads for each amplifier viewable via front panel LCD
- Announcing group assignment for each amplifier configured via front panel LCD and encoder
- Interfaces with E&M trunk lines or analog lines for announcements through a PBX system. (VoIP coming soon)
- Provides up to 3,000 watts of audio power via 12 250 watt Class D amplifier modules based on a continuous sinusoidal 1 KHz input signal at 55°C.
- Amplifiers provide for dynamic attenuation with excessive loading and automatic disconnection from load for short circuit protection. All amps have transformer isolation.
- Modular amplifiers include the capability of automatically switching the load from a faulty amplifier to a spare
- Includes 5KVA Inverter, Battery Chassis, Enhanced Alarm Module and Trunk Module
- Amplifier chassis fits in standard EIA 19" rack.
- Replaces the equivalent legacy equipment: (Qty 3 AM-2316E/SIA 1,000 watt amplifiers and Qty 1 AN/SIA-114, AN/SIA-117 or AN/SIA-118 amplifier-oscillator control group.)
- Dual digital trunks can network up to 64 DIAS nodes.

RELATED EQUIPMENT

EQUIPMENT	DYNALEC PART #
MIC STATION	60173-000-10
AMPLIFIER MODULE, 250 WATT	60173-370
DCCF, DIAS Cross Connect Field	60173-900

ENVIRONMENTAL CHARACTERISTICS

TESTED TO:

Shock	MIL-STD-901D
Vibration	MIL-STD-167-1
EMI	Mil-Std-461
Temperature	55°C

Height	74.00"
Width	24.25"
Depth	37.36"
Weight	1,026 lbs

OUTLINE DRAWINGS

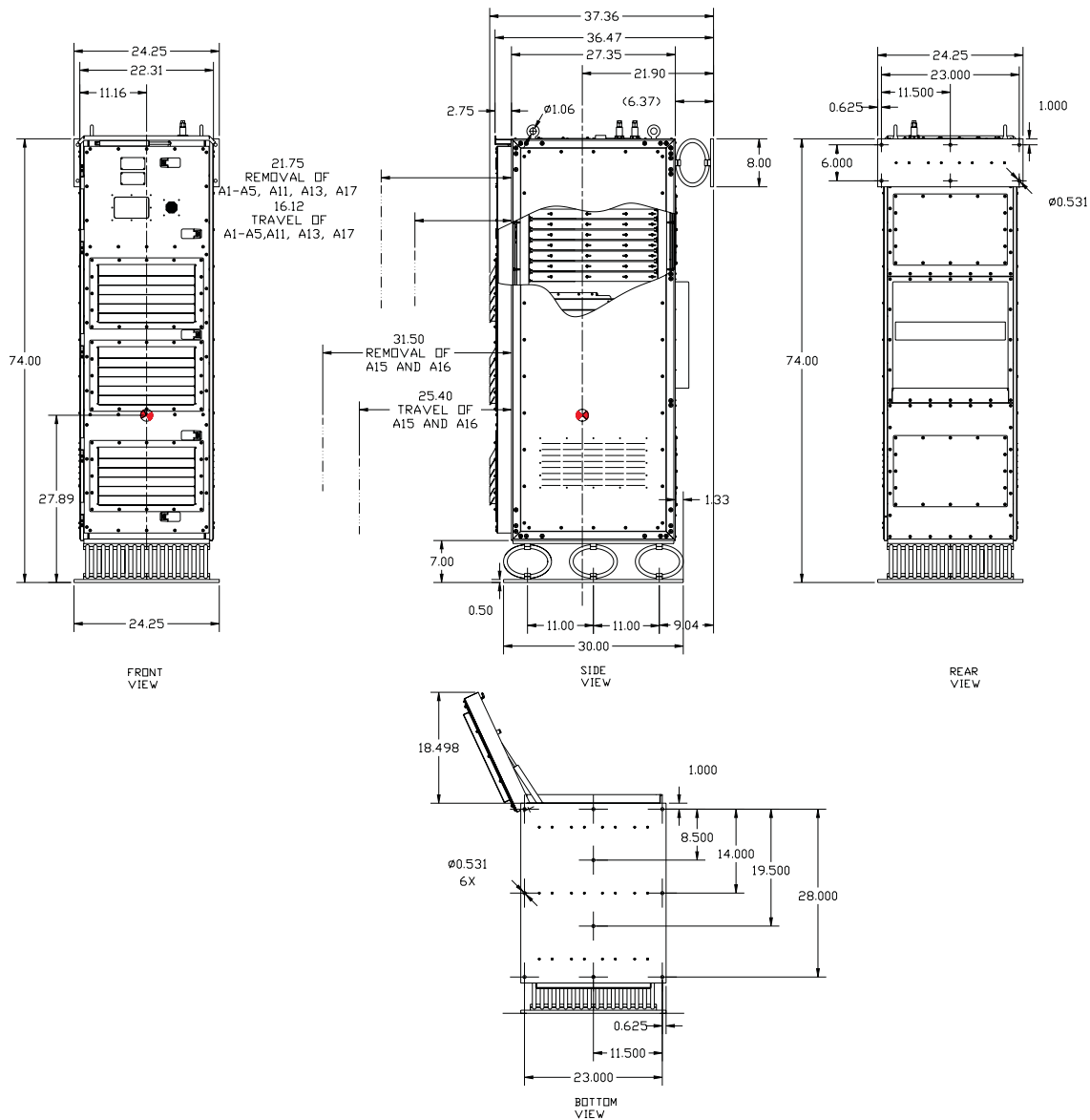

87 WEST MAIN STREET
SODUS, NEW YORK 14551

Telephone
Fax
Internet

315-483-6923
315-483-6656
www.Dynalec.com